

EDGE VENT

Edge Vent with Weather Protection



The TopShield™ Edge Vent, a residential attic ventilation has a shingle-over, edge-of-roof installed edge vent – it not only provides continuous intake airflow at the roof's edge, but it significantly simplifies intake vent installation by keeping the roofing contractor on the roof.

The Edge Vent puts the roofing contractor in complete control of the entire attic ventilation system. He no longer has to depend on the framer or the siding installer for intake vents.

The Edge Vent delivers both proper airflow and weather protection. It can be installed with confidence in all climates. Use on homes with or without overhangs; it can be placed up the roof with open soffit construction. Add the TopShield™ Edge Vent to any roof to supplement existing intake vents.

FEATURES

- Roof-top installation eliminates working overhead with soffits, under eaves.
- Roofing contractor has complete control over the intake and the exhaust vents.
- 3/4" low profile helps it blend in with roof.
- Each 4-foot piece has an integrated end plug on both ends to provide a finished appearance and weather protection.
- 9 square inches of Net Free Area per linear foot perfectly balances with other exhaust vents.
- **Patented internal baffles** and **drainage system** along with an **internal weather filter** provide 3 levels of weather protection.
- Curved top profile design allows for increased airflow over linear tapered designs.
- Copolymer construction.
- Locating tabs on the underside of the Edge Vent assist with positioning the vent over the slot.
- Minimum 3/12 roof pitch with no maximum.
- Passed 30-day ice dam test.

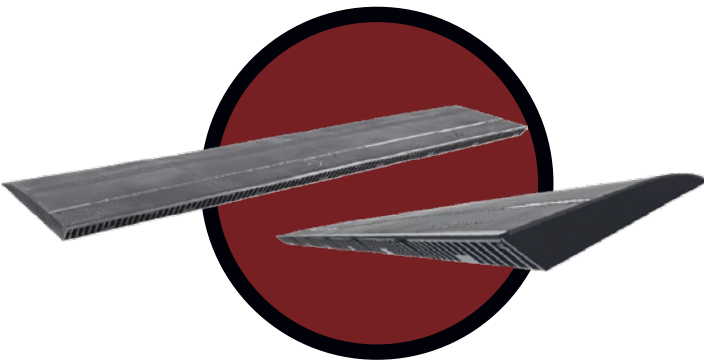

Scan the QR code
to access additional
information



A Closer Look at the TopShield™ Edge Vent

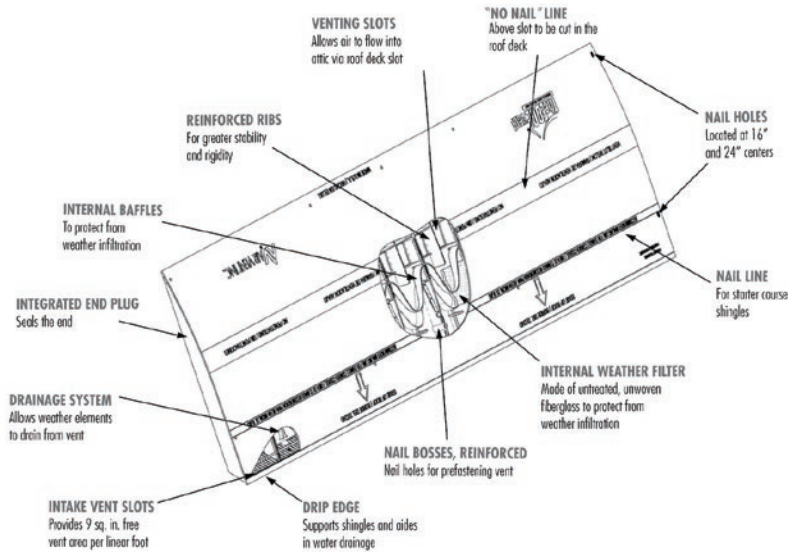

EDGE VENT INSTALLATION STEPS

1. Install roof edge flashing and gutter straps as necessary.
2. Cut 3/4" slot opening starting 5 inches from the roof's edge and lay climate-appropriate underlayment (felt or waterproofing membrane) on the bare deck - remove underlayment from the slot opening.
3. Position the edge intake vent over the slot.
4. Install climate-appropriate underlayment over the intake vent.
5. Start shingling.

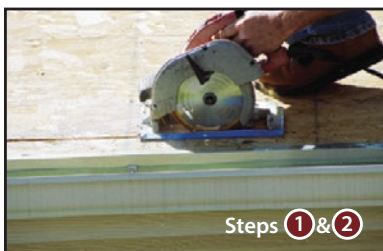

Note: Complete step-by-step installation instructions are included inside the product carton.

THE BALANCED SYSTEM® FOR ATTIC VENTILATION

Research has shown that the best way to ventilate an attic is with a system that provides continuous airflow along the entire underside of the roof sheathing. Achieving this desired airflow requires a balanced system of intake ventilation low at the roof's edge and exhaust ventilation at the ridge. This will help fight heat buildup in the summer, moisture buildup in the winter, and help defend against ice dams.

The TopShield™ Edge Vent's 9 square inches of Net Free Area per linear foot perfectly balances with Air Vent's ShingleVent II and VenturiVent Plus ridge vents, as well as other exhaust vents. It's part of The Balanced System® for Attic Ventilation.

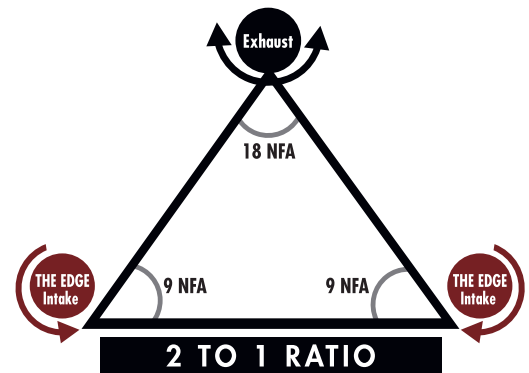

Limited Lifetime Warranty and 5-Year Replacement Plus™ Protection

Replacement Plus protection provides reimbursement for all labor costs incurred in removing any defective vent and installing the vent replacement, in addition to the replacement product itself.

Scan the QR code to access additional information

